



Let **UK** Home

1 Bedrooms

Flat

Located in London

£3,293 Per Month



info@letukhome.co.uk

<https://www.letukhome.co.uk/>

01795 358 886



4B Merchant Square London

W2 1AN



Let UK Home are excited to offer a stunning interior designed apartment, set within the heart of the Paddington Basin and close to the popular West End Quay.

The stunning apartment comprises of spacious living and entertaining space with a beautiful reception room, a superb modern fitted open plan kitchen, one bedroom, one bathroom and ample storage space.

The apartment is situated on the sixth floor of this prestigious building which features both a concierge and lift service as well as secure underground parking.

The apartment offers easy access to superb transport links such as Paddington Railway and Underground Station (Elizabeth Line, Bakerloo, Hammersmith & City, Circle, District lines and Heathrow Express) and Edgware Road Underground Station (Circle, District and Bakerloo lines).

4B Merchant Square London

£3,293 Per Month

- 6th Floor
- Private underground parking spaces
- Four minute walk from Edgware Road underground station
- No agency fees
- Lifts
- concierge service
- Available furnished or unfurnished
- Dedicated building manager
- CCTV
- Digital TV



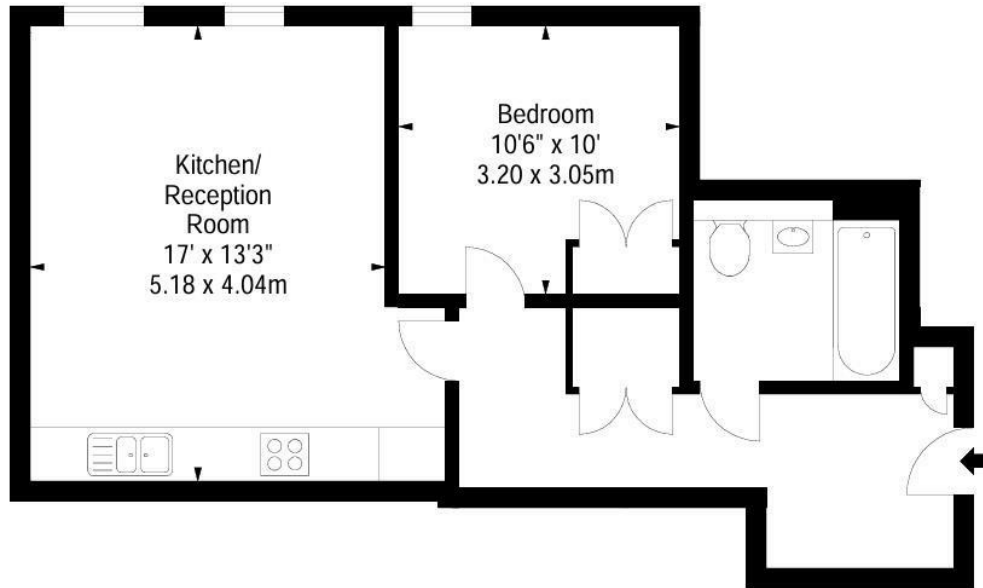

Let **UK** Home

3F 2 Eastbourne Terrace
Paddington
London
W2 6LG

01795 358 886

info@letukhome.co.uk

Council Tax Band: D

Local Authority:

Agents Note: Whilst every care has been taken to prepare these particulars, they are for guidance purposes only. All measurements are approximate and are for general guidance purposes only and whilst every care has been taken to ensure their accuracy, they should not be relied upon and potential buyers/tenants are advised to recheck the measurements.

Energy Efficiency Rating		
	Current	Potential
Very energy efficient - lower running costs		
(92 plus) A		
(81-91) B		
(69-80) C		
(55-68) D		
(39-54) E		
(21-38) F		
(1-20) G		
Not energy efficient - higher running costs		
England & Wales		
EU Directive 2002/91/EC		

<https://www.letukhome.co.uk/>